

NOPAK

SPHERICAL EYE PIN MOUNT CYLINDERS

1 1/2" THROUGH 6" DIA.

MODEL UE (USA STD. NONE) ▲

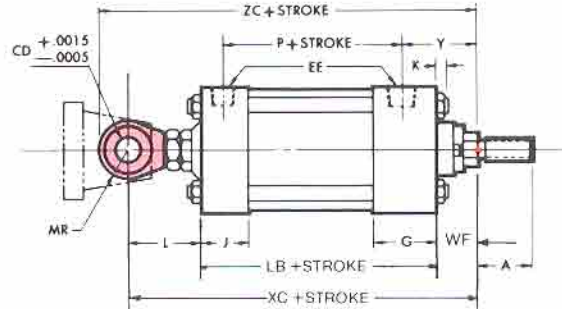
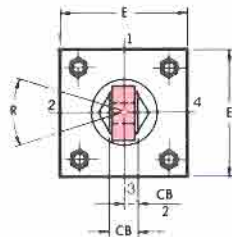
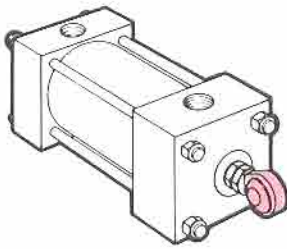

MODEL UUE (USA STD. NONE) ▲

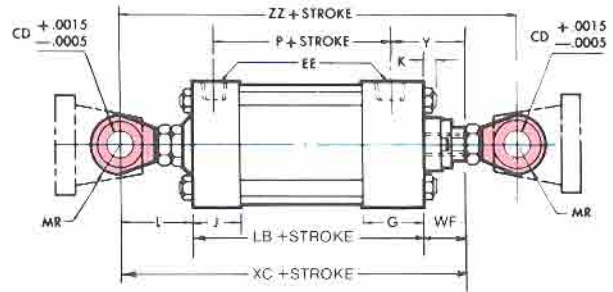
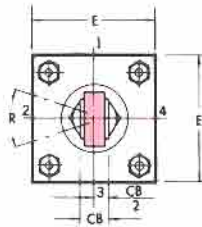
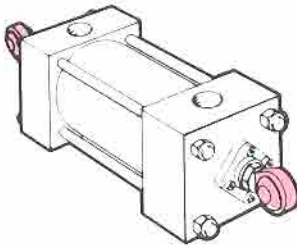

TABLE 2

These dimensions are constant regardless of rod diameter or stroke.

BORE DIA.	E	F	G	K	L	R	CB	CD	EE	MR
1 1/2	2	3/8	1 1/2	1/4	1 7/8	12°	5/8	1/2	3/8	11/16
2	2 1/2	3/8	1 1/2	3/8	1 7/8	12°	5/8	1/2	3/8	11/16
2 1/2	3	3/8	1 1/2	5/16	1 7/8	12°	5/8	1/2	3/8	11/16
3 1/4	3 3/4	5/8	1 3/4	7/16	2 7/8	13 1/2°	7/8	3/4	1/2	7/8
4	4 1/2	5/8	1 3/4	7/16	2 7/8	13 1/2°	7/8	3/4	1/2	7/8
5	5 1/2	5/8	1 3/4	1/2	2 7/8	13 1/2°	7/8	3/4	1/2	7/8
6	6 1/2	3/4	2	9/16	4 1/8	14°	1 3/8	1	3/4	1 3/8

▲ See Table A on page 27 for bore and rod combinations using head plates with threaded bronze glands.

MODEL UE & UUE CYLINDER DIMENSIONAL DATA

TABLE 1

The dimensions given on this table are affected by the piston rod diameter and the stroke.

- Heads bored for these rod sizes are normally in stock — thus faster delivery.
- * For piston rod dimensions see page 32.

BORE DIA.	* ROD MM	A	P	Y	LB	W	WF	XC	ZC	ZZ
1 1/2	5/8 •	3/4	2 1/8	1 15/16	3 5/8	5/8	1	6 1/2	7 3/16	7 11/16
	1 •	1 1/8		2 5/16		1	1 3/8	6 7/8	7 9/16	8 1/16
2	5/8 •	3/4	2 1/8	1 15/16	3 5/8	1	1	6 1/2	7 3/16	7 11/16
	1 •	1 1/8		2 5/16			1 3/8	6 7/8	7 9/16	8 1/16
	1 3/8	1 5/8		2 9/16			1 1/4	7 1/8	7 13/16	8 5/16
2 1/2	5/8 •	3/4	2 1/4	1 15/16	3 3/4	1 1/2	1	6 5/8	7 5/16	7 13/16
	1 •	1 1/8		2 5/16			1 3/8	7	7 11/16	8 3/16
	1 3/8 •	1 5/8		2 9/16			1 5/8	7 1/4	7 15/16	8 7/16
	1 3/4	2		2 13/16			1 7/8	7 1/2	8 3/16	8 11/16
3 1/4	1 •	1 1/8	2 1/2	2 1/2	4 1/4	1 3/8	1 3/8	8 1/2	9 3/8	10 1/16
	1 3/8 •	1 5/8		2 3/4			1 5/8	8 3/4	9 5/8	10 5/16
	1 3/4 •	2		3			1 7/8	9	9 7/8	10 9/16
	2	2 1/4		3 1/8			2	9 1/8	10	10 11/16
4	1 •	1 1/8	2 1/2	2 1/2	4 1/4	1 5/8	1 3/8	8 1/2	9 3/8	10 1/16
	1 3/8 •	1 5/8		2 3/4			1 5/8	8 3/4	9 5/8	10 5/16
	1 3/4 •	2		3			1 7/8	9	9 7/8	10 9/16
	2	2 1/4		3 1/8			2	9 1/8	10	10 11/16
	2 1/2	3		3 3/8			2 1/4	9 3/8	10 1/4	10 15/16
5	1 •	1 1/8	2 3/4	2 1/2	4 1/2	1 5/8	1 3/8	8 3/4	9 5/8	10 5/16
	1 3/8 •	1 5/8		2 3/4			1 5/8	9	9 7/8	10 9/16
	1 3/4	2		3			1 7/8	9 1/4	10 1/8	10 13/16
	2	2 1/4		3 1/8			2	9 3/8	10 1/4	10 15/16
	2 1/2	3		3 3/8			2 1/4	9 5/8	10 1/2	11 3/16
	3	3 1/2		3 3/8			2 1/4	9 5/8	10 1/2	11 3/16
	3 1/2	3 1/2		3 3/8			1 5/8	2 1/4	9 5/8	10 1/2
6	1 3/8 •	1 5/8	3 1/8	2 13/16	5	1 1/2	1 5/8	10 3/4	12 1/8	13 5/16
	1 3/4 •	2		3 1/16			1 7/8	11	12 3/8	13 9/16
	2 •	2 1/4		3 3/16			2	11 1/8	12 1/2	13 11/16
	2 1/2	3		3 7/16			2 1/4	11 3/8	12 3/4	13 15/16
	3	3 1/2		3 7/16			2 1/4	11 3/8	12 3/4	13 15/16
	3 1/2	3 1/2		3 7/16			2 1/4	11 3/8	12 3/4	13 15/16
	4	4		3 7/16			1 1/2	2 1/4	11 3/8	12 3/4

TABLE A

THE FOLLOWING BORE/ROD COMBINATIONS USE HEAD PLATE AND BRONZE GLANDS AS SHOWN AT RIGHT.

BORE	ROD DIAMETER (MM)
1 1/2	5/8 & 1
2	1 & 1 1/8
2 1/2	1 3/4
3 1/4	2
4	2 1/2
5	3 1/2
6	4

Bolt-on glands not available on these combinations.
 Note: Threaded Bronze Gland used on all Model D Cylinders. Bolt-on Gland used on all Model DG Cylinders.

